

# WAVEPACE® Lightweight concrete plinth

Accessory for the splice splitter patch outdoor cabinet



77700902  
Concrete-Base-Fiber-Cabinet



## Lightweight concrete base for WAVEPACE® Fiber Cabinet

- Modular lightweight concrete base for quick assembly with removable inspection panel on the front for use with the WAVEPACE® Fiber Cabinet
- The low weight of the individual components facilitates simple assembly
- Smallest housing dimensions, only 20 cm installation depth
- Height from ground level approx. 300 mm
- Designed for a housing with mounting dimensions 635 x 103 mm
- Very space-saving delivery of the dismantled base on one-way pallet

Parameter	Concrete-Plinth-Fiber-Cabinet
Application	Ground plinth for Fiber Cabinet
Total dimensions (H x W x D) [mm]	1.000 x 700 x 200
Dimensions base plate (H x W x D) [mm]	55 x 880 x 350
Weight [kg]	190
Material	Lightweight concrete, concrete quality min. LC 25/28 D1,8
Order No.	77700902

### Profile

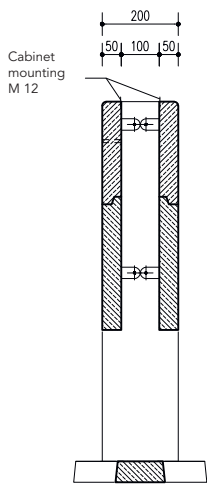

### Front view/profile

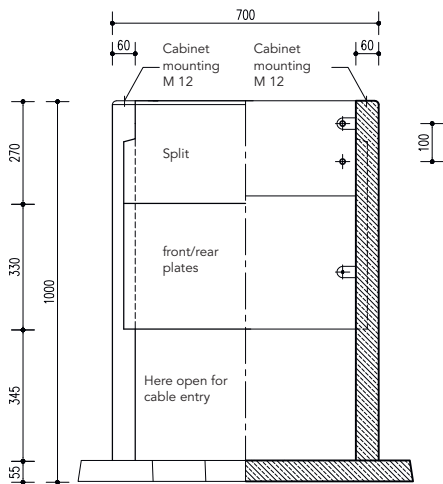

### Top view

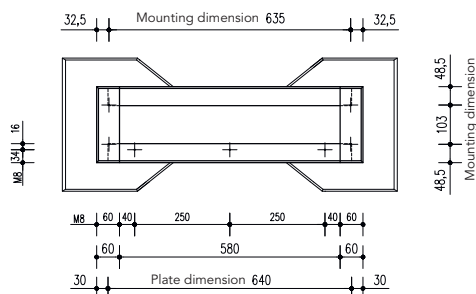

WAVEPACE® Fiber-Cabinet-P2MP  
with mounted lightweight concrete plinth